



Shear Beam Type Load Cell

Single ended Shear Beam LoadCell are designed for low profile platform scales. Besides these they are also used for industrial automation applications, hopper, tank weighing systems. They are made from high tool steel alloy with Electroless nickle plating for protecting loadcells from jerk loads & corrosion. These LoadCells are temperature compensated from 0°C to +60°C with moisture protection. They are IP67 protected (protection against normal water sprinkle). (Please check **Aware Your Knowledge** in menubar for IP Standards)

Features

- ◆ Alloy steel construction and hermetically sealed having IP67 protection
- ◆ Available from 22.5 kg. to 10000 kg. capacities
- ◆ Low profile
- ◆ Also available in Stainless Steel

Application

- ◆ Mainly used in Construction Equipments & Batching Plants as Sensors
- ◆ Low profile platform scales above 1200x 1200mm
- ◆ Industrial Automation Applications
- ◆ Hopper, Tank Weighing Systems
- ◆ Baggage Weighing

Standard Capacities (Kg.)

22.5, 50, 100, 150, 250, 300, 500, 750, 1000, 1500, 2000, 3000, 5000, 10000

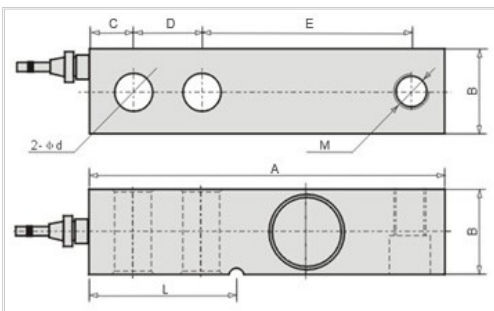

Standard Specification :

Nominal Output	3.0mV/V(mili Volt per Volt)
Excitation Voltage	9 -12 VDC (Maximum 15 VDC)
Safe Load	150% of Rated Capacity
Ultimate Load	200% of Rated Capacity
Allowable Side Load	50% of Rated Capacity
Non Linearity	<±0.025% of FSO (Full Scale Output)
Creep (30 minutes)	<±0.030% of FSO
Non-Repeatability	≤±0.020% of FSO
Zero Balance	±1% of FSO
Input Resistance	350 ± 5 ohms
Output Resistance	350 ± 5 ohms
Insulation resistance	Above 5000 Mega ohms
Temp. Compensation	-10°C to +40°C
Temp. Effect on Zero	≤± 0.030% of FSO/10 °C
Material	Electroless Nickle Plated Tool Steel
Environmental Protection Class	IP67.
Connection	Input : +(Red) - (Black) Output : +(Green) - (White)

Rated Load	A	B	C	D	E	M	d	L
22.5 kg -2T	130	31.8	15.8	25.4	76.2	M12*1.25	13.5	54.2
3T - 5T	172	38	19	38	95	M20*1.50	21	76